



THE UNIVERSITY OF

MELBOURNE

Archives Digitised Collections

Creator(s)

Yura, Shigeru

Title

Plan and elevation of Japanese Room in University of Melbourne, New School of Architecture

Date

1962-1964

Description

Sub-item: 1976.0012.00012

Terms and Conditions

This image is in copyright and can only be viewed at the University of Melbourne Archives. For information about ordering a copy of this image contact the University of Melbourne Archives: archives@archives.unimelb.edu.au.

Preferred Citation

University of Melbourne Archives, Yura, Shigeru, Plan and elevation of Japanese Room in University of Melbourne, New School of Architecture , 1976.0012.00012

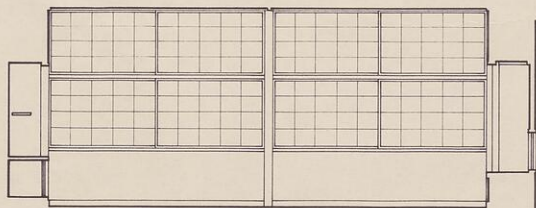

EAST.

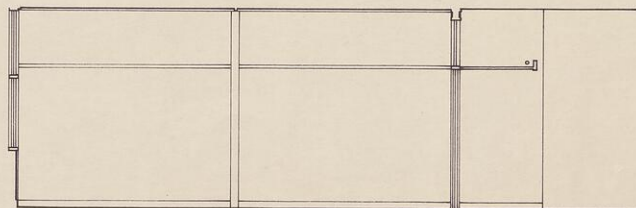

WEST.

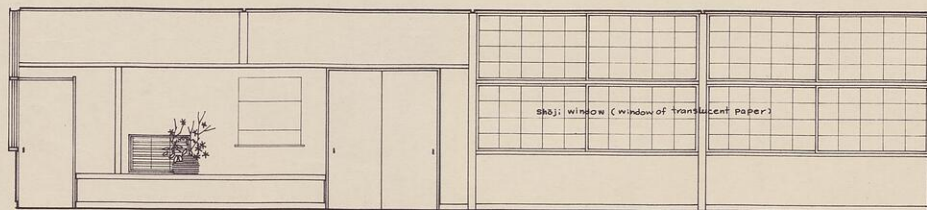

SOUTH.

ELEVATION SCALE 1" = 4'0"

JAPANESE ROOM

UNIVERSITY OF MELBOURNE
NEW SCHOOL OF ARCHITECTURE

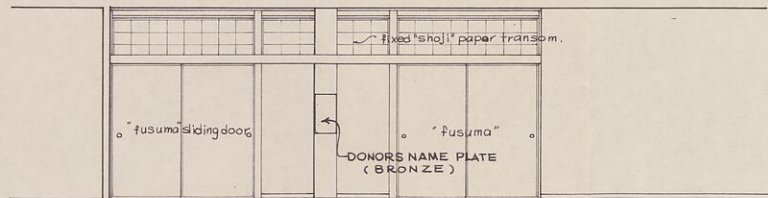

SOUTH (CORRIDOR)



SOUTH

ELEVATION SCALE 1"=4'-0"

JAPANESE ROOM

UNIVERSITY OF MELBOURNE
NEW SCHOOL OF ARCHITECTURE